

Frame Installation

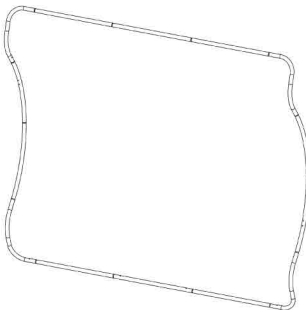

STEP 1 :

Connect all the pipes together \ according to the sticker number on each pipe. Make sure it is the same sticker number before you join the pipes. (Do not attach the legs yet).

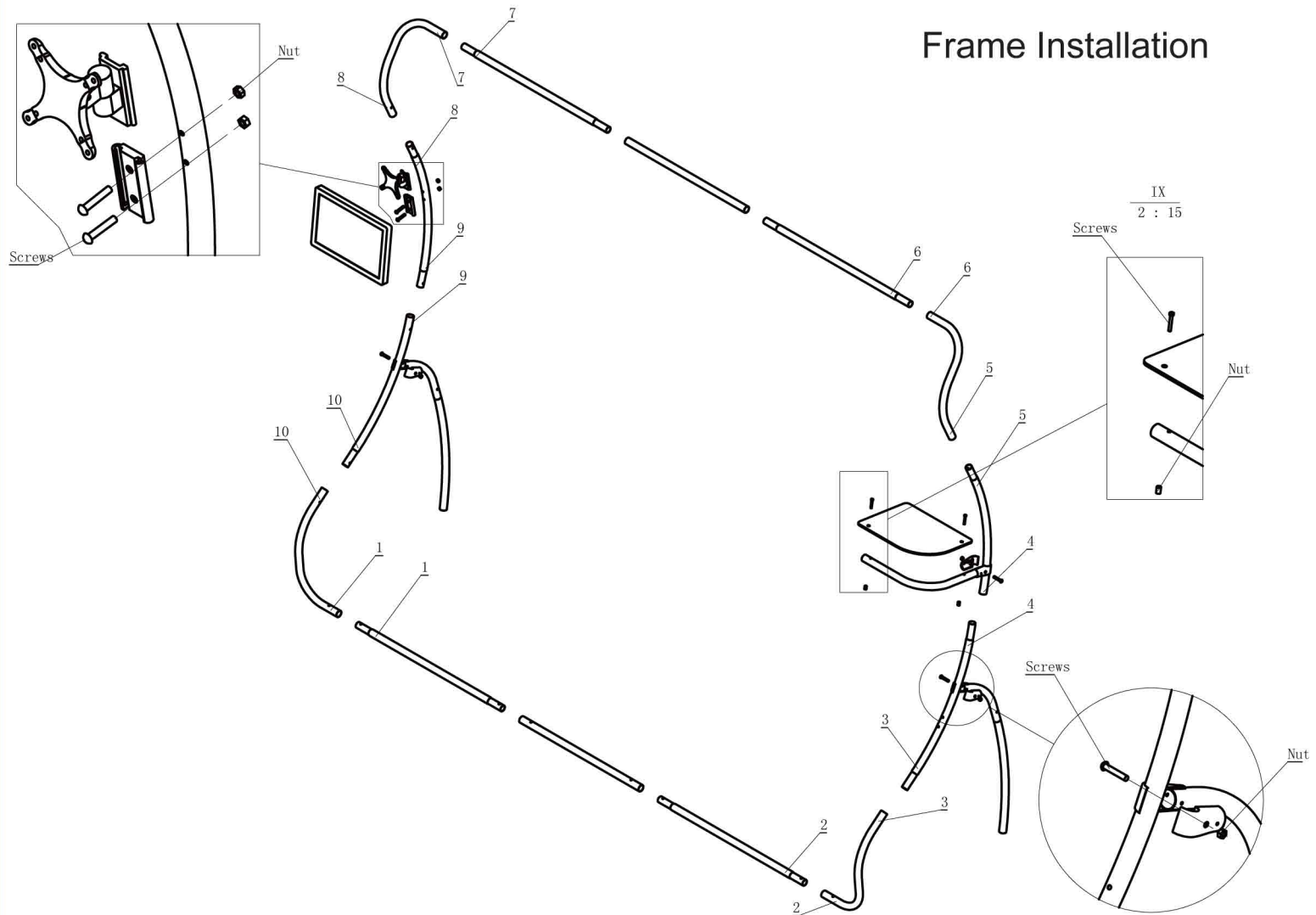
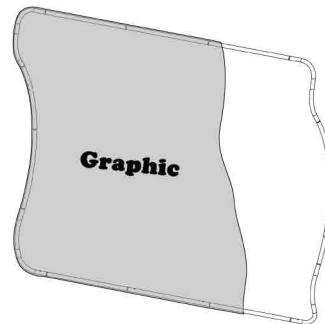

STEP 2 :

Put the graphic on the frame just like you put a pillowcase on a pillow. Zip up the graphic holding together the zipper sides.

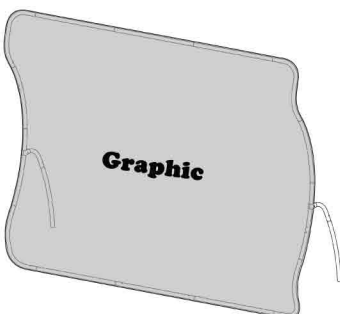

STEP 3 :

Install the legs.

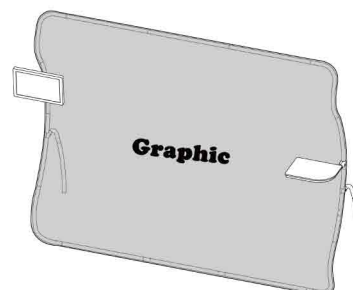

STEP 4 :

Attach the monitor mounts, shelf and lights. (note: over-tightening the lights may result in damage to the graphic print)